

# KESWICK ESTATE

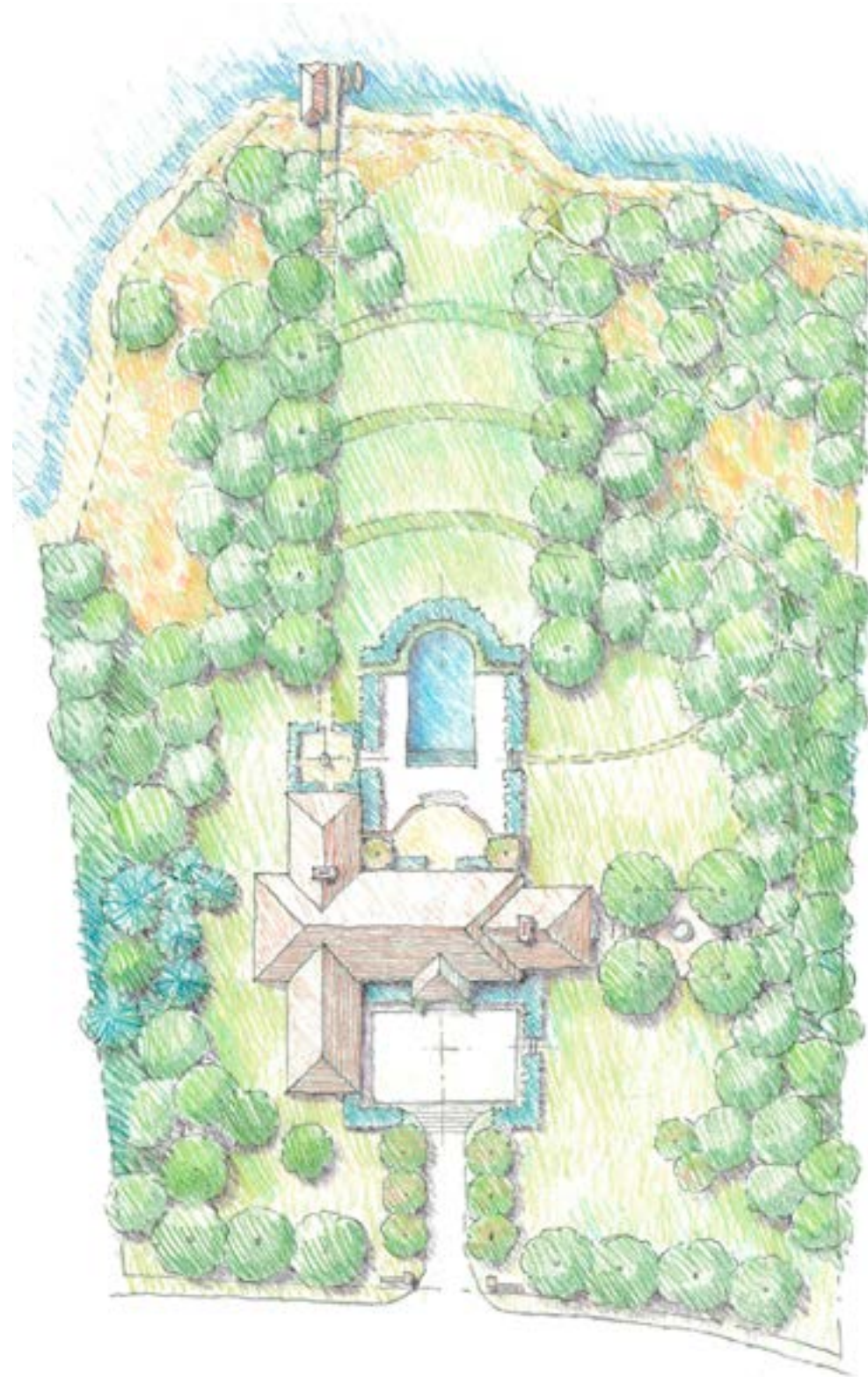



# LOT 60

## PALMER DRIVE

Lot 60 is located within a quiet, wooded, mostly undeveloped section of Keswick Estates near the cul-de-sac of Palmer Drive. The lot slopes down from the street toward the lake, where it has continuous lake frontage. The rear yard has excellent southern exposure. The home site design in the illustration reserves the rear yard for a series of terraces that step down toward the lake. The house is centered on the lot frontage and located close to the front of the property with a formal driveway and parking court, allowing flexibility for development of the yards. Parts of the fully-wooded lot are cleared for lawns and meadows, retaining the best groupings of trees, and selectively adding new trees to frame “outdoor rooms.” The t-shaped floor plan is fitted to the site that would work well for single story living. It would provide excellent daylight with multiple exposures and views. One pathway along the terraces leads to a dock on the lake, and others wind through meadows and woodlands. This is a lot full of possibilities that can be created to suit every lifestyle.

## SCHEMATIC LOT LAYOUT



### SITE KEY

1. Formal Driveway with Stone Entry Pillars
2. Motorcourt with Evergreen Hedge & Sculpture
3. Main House
4. Stone Terrace & sitting area
5. Hedged, Formal Gardens
6. Natural Forest Edge & Evergreen Screen
7. Pool with Infinity Edge Overlooking Pond
8. Terraced Lawn with Trail to Water's Edge
9. Kayak Dock on Water's Edge
10. Carroll Creek

## LOT LOCATION IN KESWICK ESTATE



## LOT PROFILE

**LOT ID**  
Lot 60

**ACREAGE**  
2.43

**ADDRESS**  
Lot 60 Palmer Drive  
Keswick, VA 22947

**PARCEL ID**  
08000-00-00-010D0

**ELEM. SCHOOL**  
Stone-Robinson

**MIDDLE SCHOOL**  
Burley

**HIGH SCHOOL**  
Monticello

**OTHER SCHOOLS**  
St. Anne's Belfield  
Covenant  
Tandem Friends

